

AGENDA PLACEMENT FORM

(Submission Deadline – Tuesday, 12:00 PM before Regular Court Meetings)

Date: March 7, 2023

COMMISSIONERS COURT

Meeting Date: March 13, 2023

MAR 13 2023

Submitted By: Ralph McBroom

Department/Office: Purchasing

Approved

Signature of Director/Official: _____

Agenda Title:

Sheriff's Office Remodeling Project

Public Description (Description should be 2-4 sentences explaining to the Court and the public what action is recommended and why it is necessary):

Consideration and Approval of change order for the Sheriff's Office Remodeling Project in the amount of \$127,543.76 to complete the project.

(May attach additional sheets if necessary)

Person to Present: Ralph McBroom

(Presenter must be present for the item unless the item is on the Consent Agenda)

Supporting Documentation: (check one) PUBLIC CONFIDENTIAL

(PUBLIC documentation may be made available to the public prior to the Meeting)

Estimated Length of Presentation: 5 minutes

Session Requested: Action (Action Item, Workshop, Consent, Executive)

Check All Departments Requiring Notification:

County Attorney IT Purchasing Auditor

Personnel Public Works Facilities Management

Other Department/Official (list) _____



13600 Heritage Parkway, Suite 150
 Fort Worth, TX 76177
 Ph: 817-926-4377
 Fax: 817-926-4387

PROPOSED CHANGE REQUEST

To: **Johnson County Sheriff's Office**
 1102 E. Kilpatrick
 Cleburne, TX 76033

Number: 15R1
 Date: 1/27/23
 Job: 211204

Description: Front Office Finish Out

		Price
1	Demo Flooring and Ceiling Tile	\$ 7,100.00
4	Sewer Line Repair	N/A
5	Ceiling Tile - 2,850 SF @\$9.75	\$27,787.00
6	Paint 9,000 SF @ \$2.00/sf	\$18,000.00
7	Corridor & Office Carpet - 320 Yds @ \$24/yd	\$7,680.00
8	4" Base 900 LF @ \$2.50/Ft	\$ 2,250.00
9	Change out electrical plates	\$ 3,200.00
10	HVAC grill replacement 20 @ \$75 ea	\$ 1,500.00
11	Restroom Floor Tile - 100 SF @ 10.50/Ft	\$ 1,050.00
12	Restroom Wall Tile 520 SF @ \$10.50/SF	\$ 5,460.00
13	Restroom Plumbing Fixtures	\$ 3,500.00
15	Supervision 5 weeks @ \$ 2,800/wk	\$ 14,000.00
17	Rework West Entry Door	\$ 22,325.00
18	West Entry Lobby	\$ 5,225.00
	SubTotal	<u>\$ 119,077.00</u>
	Insurance 0.87%	\$1,035.97
	Subtotal:	<u>\$120,112.97</u>
	OH & Fee 5.00%	\$6,005.65
	Subtotal:	<u>\$126,118.62</u>
	Bond 1.13%	\$1,425.14
	Change Order Amount	<u>\$127,543.76</u>

Exclusions

1. Furniture removal & replacement
2. Replacement or relocation of existing duct work and equipment
3. Abatement
4. Inspection of existing sewer line and repair
5. Restroom Accessories
6. Contingency money
7. Lighting or Electrical Upgrades

Attachments:

1. Supp. Dwg. #18
2. Supp. Dwg. #18 - Rm. Finish Sch.
3. Supp. Dwg. #32B
4. Supp. Dwg. #34A, 34B, & 34C

Approvals:
 Johnson County
 Date: 3-13-23

[Signature]
3-13-23

Robert Durham *[Signature]*
 Date: 03-07-2023

Approvals:
 AUI Partners
 Date: 1/27/2023

[Signature]
1/27/2023

Johnson County Sheriff's Office Renovation									
Finish Schedule - Phase 4									
4/29/22									
							Wall		
Room Number	Room Name	Base	Floor	North	East	South	West	Ceiling Finish	Net Area
100	A-Bail Bond	1	5	2	2	2	2	6	154 SF
101	A-Break Rm.	1	1	1/A	1/A	1/A	1/A	1	587 SF
102	A-Chief Dep.	1	5	2	2	2	2	6	223 SF
103	A-Chief Dep.	1	5	2	2	2	2	6	227 SF
104	A-CID Capt.	1	5	2	2	2	2	6	143 SF
105	A-Clerical	1	5	2	2	2	2	6	404 SF
106	A-Clos.	1	1	2	2	2	2	2	6 SF
107	IT	NA	NA	2	2	2	2	2	48 SF
108	A-Corp.	1	5	2	2	1/A	2	2	182 SF
109	A-Corridor	1	1	1/A	NA	2	2	1	450 SF
110	A-Corridor	1	1	1/A	2	1/A	1/A	1	234 SF
112	A-Fire Marsh.	1	1	2	2	2	2	6	150 SF
113	A-Harden	1	5	2	2	2	2	6	81 SF
114	A-Lift	NA	3	2	1/A	1/A	1/A	3	49 SF
115	A-Lobby	1	1	2	2	2	2	6	289 SF
116	A-Men	NA	NA	NA	NA	NA	NA	NA	94 SF
117	A-Men	2	4	1/A	1/A	1/A	1/A	4/A	228 SF
118	A-Records	1	1	2	2	2	2	6	323 SF
119	A-Restrm.	NA	NA	NA	NA	NA	NA	NA	42 SF
120	Office	1	5	2	2	2	2	6	370 SF
121	A-Stair	1	1	1/A	1/A	1/A	1/A	3	110 SF
122	A-Support	1	5	2	2	2	2	6	325 SF
124	A-Training	3	1	1/A	1/A	1/A	1/A	1	3453 SF
125	A-Training Officer	1	5	2	2	2	2	6	135 SF
126	Sheriff's Office	3	5	1/A	1/A	1/A	1/A	1	511 SF
127	A-Vest.	3	1	2	2	NA	2	1	74 SF
128	A-Women	NA	NA	NA	NA	NA	NA	NA	39 SF
129	A-Women	2	4	1/A	1/A	1/A	1/A	4/A	232 SF
130	Chaplin	1	5	2	1/A	1/A	1/A	1	93 SF
131	Corridor	3	1	2	1/A	1/A	1/A	1	217 SF
132	Vestibule	3	1	1/A	1/A	1/A	NA	1	60 SF
133	Corridor	3	1	1/A	1/A-2	1/A	1/A	1	434 SF
134	E-Crime Lab	1	NA	2	2	2	2	2	286 SF
135	E-Evidence Officer	1	2	2	1/A	2	1/A	2	110 SF
136	E-Fire	NA	NA	2	2	2	2	2	269 SF
137	E-Processing	1	1	1/A	1/A	1/A	1/A	1	119 SF
138	E-Property Mgr.	1	1	2	2	2	2	6	248 SF
139	Elect.	NA	3	1/A	1/A	1/A	1/A	3	68 SF
141	I-Corridor	3	1	1/A	1/A	1/A	1/A	1	1869 SF
142	I-Corridor	3	1	1/A	1/A	1/A	1/A	1	559 SF
143	I-Lab	1	1	2	2	2	2	6	62 SF
144	I-Corridor	3	1	1/A	NA	1/A	NA	1	95 SF

Room Number	Room Name	Base	Floor	North	East	South	West	Ceiling Finish	Net Area
145	I-Interview	1	5	2	2	2	2	6	164 SF
146	I-Interview	1	5	1/A	1/A	1/A	1/A	1	120 SF
147	I-Lab	1	5	2	2	2	2	6	56 SF
148	A-Corridor	1	1	2	2	2	2	2	117 SF
149	A-Corridor	NA	NA	2	2	2	2	2	393 SF
160-I	I-Office	1	5	1/A	1/A	1/A	1/A	1	104 SF
161-I	I-Office	1	5	1/A	1/A	1/A	1/A	1	117 SF
162-I	I-Office	1	5	1/A	1/A	1/A	1/A	1	117 SF
163-I	Mech.	1	5	1/A	1/A	1/A	1/A	1	98 SF
164-I	I-Office	1	5	1/A	1/A	1/A	1/A	1	144 SF
165-I	I-Office	1	5	1/A	1/A	1/A	1/A	1	136 SF
166-I	I-Office	1	5	1/A	1/A	1/A	1/A	1	98 SF
167-I	I-Office	1	5	1/A	1/A	1/A	1/A	1	136 SF
168-I	I-Office	1	5	1/A	1/A	1/A	1/A	1	106 SF
169-I	I-Office	1	5	1/A	1/A	1/A	1/A	1	106 SF
170-I	I-Office	1	5	1/A	1/A	1/A	1/A	1	106 SF
171-I	I-Office	1	5	2	1/A	1/A	1/A	1	103 SF
172-I	I-Office	1	5	2	1/A	1/A	1/A	1	100 SF
173-I	I-Office	1	5	2	1/A	1/A	1/A	1	100 SF
174-I	I-Office	1	5	2	1/A	1/A	1/A	1	100 SF
175-I	I-Office	1	5	2	2	2	2	1	169 SF
176-I	I-Office	1	5	1/A	1/A	2	1/A	1	108 SF
177-I	I-Office	1	5	1/A	1/A	1/A	1/A	1	105 SF
178-I	I-Office	1	5	1/A	1/A	1/A	1/A	1	105 SF
179-I	I-Office	1	5	1/A	1/A	1/A	1/A	1	146 SF
180-I	I-Office	1	5	1/A	1/A	1/A	1/A	1	105 SF
181-I	I-Office	1	5	1/A	1/A	1/A	1/A	1	105 SF
182-I	I-Office	1	5	2	1/A	1/A	1/A-2	1	177 SF
183-I	I-Office	1	5	1/A	1/A	1/A	1/A	1	105 SF
184-I	I-Office	1	5	2	1/A	1/A	1/A	1	105 SF
185-I	I-Office	1	5	1/A	1/A	1/A	1/A	1	102 SF
186-I	I-Office	1	5	1/A	1/A	1/A	1/A	1	102 SF
187-I	I-Office	1	5	1/A	1/A	1/A	1/A	1	102 SF
188-I	I-Office	1	5	1/A	1/A	2	1/A	1	150 SF
189-I	I-Office	1	5	1/A	1/A	1/A	2	1	98 SF
190-I	I-Office	1	5	1/A	1/A	1/A	1/A	1	106 SF
191	I-Support	1	5	2	2	1/A	2	1	70 SF
192	Interview	1	5	2	1/A	1/A	1/A	1	95 SF
193	Interview	1	5	2	1/A	1/A	2	1	95 SF
194	Interview	1	5	2	1/A	1/A	1/A	1	95 SF
195	Men Dress	2	4	1/A	1/A	2	2	4/A	59 SF
196	Men Shower	2	4	3	3	3	3	4/A	24 SF
197	P-Brief	NA	NA	2	2	2	2	2	527 SF
198	P-Capt.	NA	NA	NA	NA	NA	NA	NA	117 SF
199	P-Clos.	NA	NA	NA	NA	NA	NA	NA	54 SF
200	P-Clos.	NA	NA	NA	NA	NA	NA	NA	12 SF

Room Number	Room Name	Base	Floor	North	East	South	West	Ceiling Finish	Net Area
201	P-Clos.	NA	NA	NA	NA	NA	NA	NA	7 SF
202	P-Clos.	NA	NA	NA	NA	NA	NA	NA	10 SF
203	P-Clos.	NA	NA	NA	NA	NA	NA	NA	19 SF
204	P-Corridor	NA	NA	NA	2	NA	NA	NA	42 SF
205	P-Lnt.	NA	NA	NA	NA	NA	NA	NA	121 SF
206	P-Meeting	NA	NA	NA	NA	NA	NA	NA	190 SF
207	P-Sgt.	NA	NA	NA	NA	NA	NA	NA	127 SF
208	P-Sgt.	NA	NA	NA	NA	NA	NA	NA	147 SF
209	P-Sgt.	NA	NA	NA	NA	NA	NA	NA	165 SF
210	P-Sgt.	NA	NA	NA	NA	NA	NA	NA	92 SF
211	P-Vest.	NA	NA	NA	NA	NA	NA	1	248 SF
212	S-Elect.	NA	NA	1/A	1/A	NA	1/A	3	75 SF
213	Store	1	1	1/A	1/A	2	1/A	1	48 SF
214	T-Office	1	5	1/A	1/A	1/A	1/A	1	103 SF
215	T-Office	1	5	1/A	1/A	1/A	1/A	1	108 SF
216	T-Office	1	5	1/A	1/A	1/A	1/A	1	108 SF
217	Vestibule	1	5	1/A	1/A- 2	1/A	2	1	391 SF
218	T-Office	1	5	1/A	1/A	1/A	1/A	1	108 SF
219	T-Office	1	5	1/A	1/A	2	1/A	1	95 SF
220	T-Office	1	5	1/A	1/A	1/A	1/A	1	108 SF
221	Women Dress	2	4	1/A	1/A	2	1/A	4/A	59 SF
222	Women Shower	2	4	3	3	3	3	4/A	25 SF
223	Corridor	3	1	1/A	1/A- 2	1/A	1/A	1	272 SF
300	Evidence - 2	NA	6	2	2	2	2	3	2819 SF
301	Evidence - 2A	NA	6	4	4	4	2	5	114 SF
302	Vestibule	NA	6	2	2	1/A	1/A	3	671 SF
303	Evidence - 2B	NA	6	4	2	4	4	5	118 SF
304	Computer								27 SF
305	Machine								27 SF
									25649 SF
	Legend								
4	Base Bid								
4	Phase 4								
	Base Bid								

Room Number	Room Name	Base	Floor	North	East	South	West	Ceiling Finish	Net Area
Room Finish Notes:									
Base:									
1	4" H Vinyl								
2	4" H Tile								
3	6" H Vinyl								
Floor:									
1	12"x12" Vinyl Composition Tile (Remove Existing Floor)								
2	Existing - patch, repair, & replace, as required								
3	Existing Concrete - no work required								
4	Tile								
5	Carpet								
6	Concrete - Smooth Finish w/ Seal Coat								
Wall:									
1	Gypsum Board (MR in wet areas)								
2	Existing - patch, repair, & replace, as required - Paint								
3	Tile								
4	Plywood - Unfinished								
Ceiling:									
1	Acoustical Lay-in								
2	Existing - Refinish / Paint								
3	Open to Structure Above								
4	5/8" Gypsum Board on Metal Framing - Paint								
5	Plywood - Unfinished on Metal Framing to Underside of Stl. Joist Above								
6	<i>Existing Gyp. Brd. - Remove Texture & Provide Medium Texture - Paint</i>								
Finish:									
A.	Light Orange Peel - Paint								
Demolition:									
A.	In areas scheduled for flooring - remove existing finish floor - patch & repair, as required, to accommodate floor as scheduled								

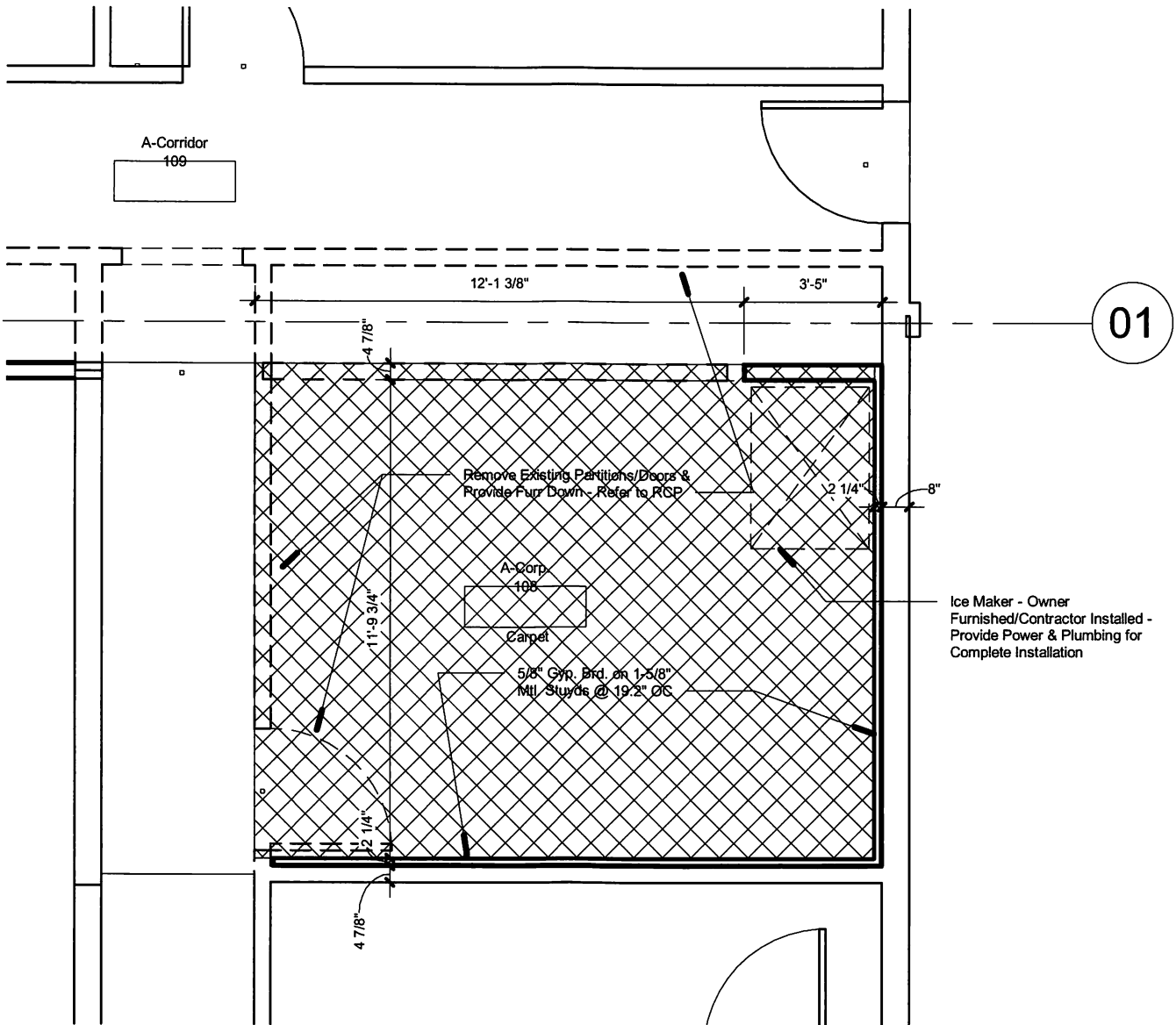

1 Level 1 - Supp. dwg 32
 1/4" = 1'-0"

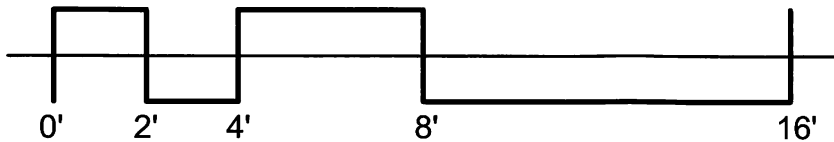

ROBERT DURHAM
 ARCHITECTURE

8545 Crichton Court
 Cleburne, TX 76033
 t 214.673.4480

robert@rdurhamarchitecture.com
 www.rdurhamarchitecture.com

A-Corp 108

Renovation - Sheriff's Office

Johnson County Sheriff's Office
 1102 E. Kilpatrick
 Cleburne, TX 76033

SD 32 A

Scale 1/4" = 1'-0"

1/4/2023 11:40:26 AM

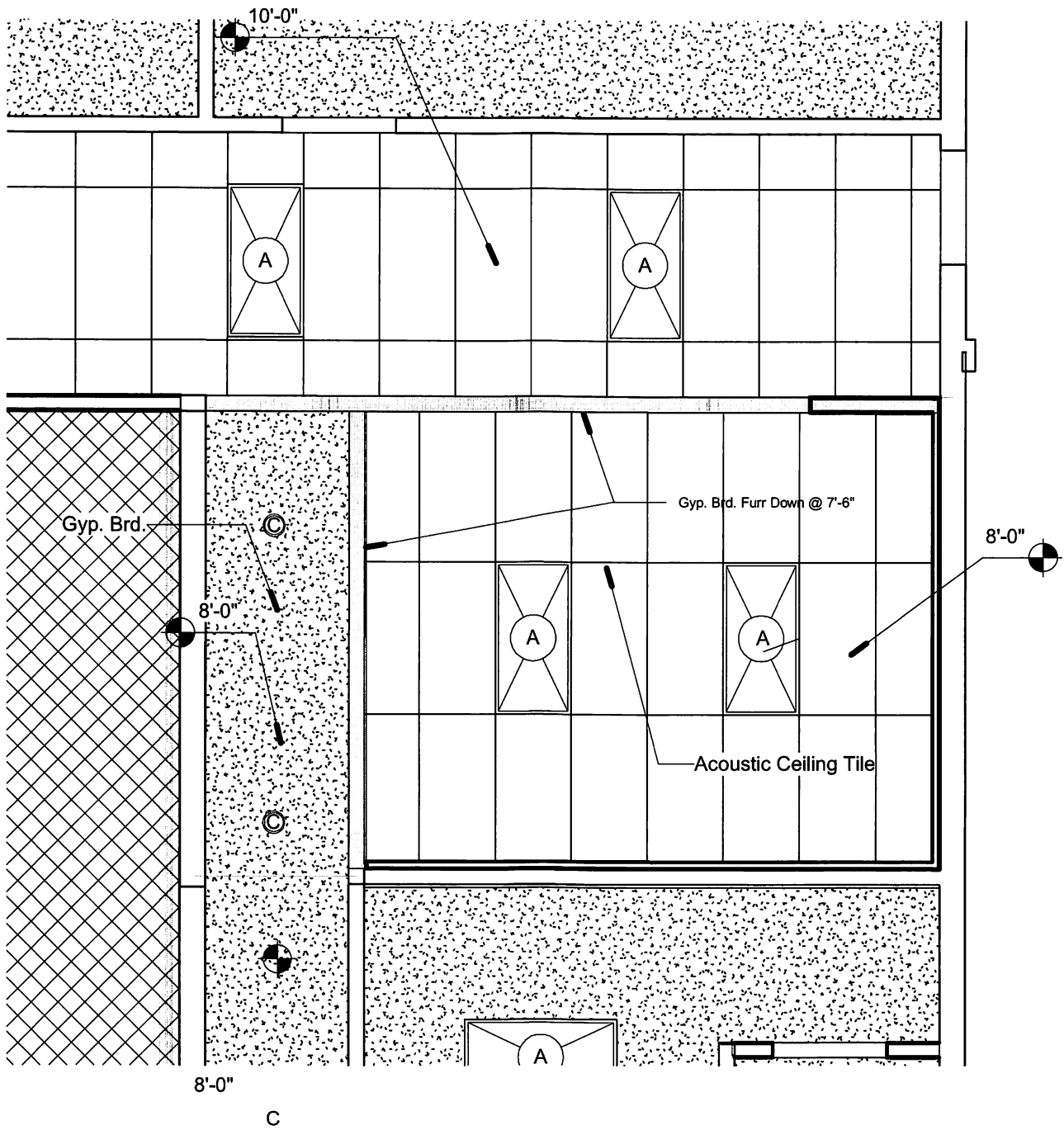

① Level 1 RCP supp. dwg. 32 B
 1/4" = 1'-0"

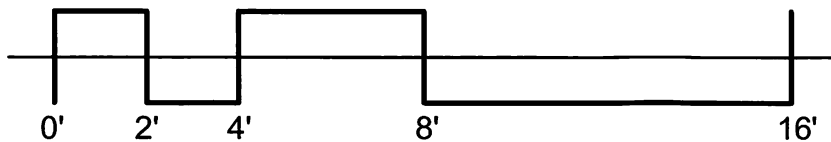

ROBERT DURHAM
 ARCHITECTURE

8546 Crichton Court
 Cleburne, TX 76033
 t 214.673.4480

robert@rdurhamarchitecture.com
 www.rdurhamarchitecture.com

RCP - A-Corp 108

Renovation - Sheriff's Office

Johnson County Sheriff's Office
 1102 E. Kilpatrick
 Cleburne, TX 76033

SD 32 B

Scale 1/4" = 1'-0"

1/4/2023 11:40:27 AM

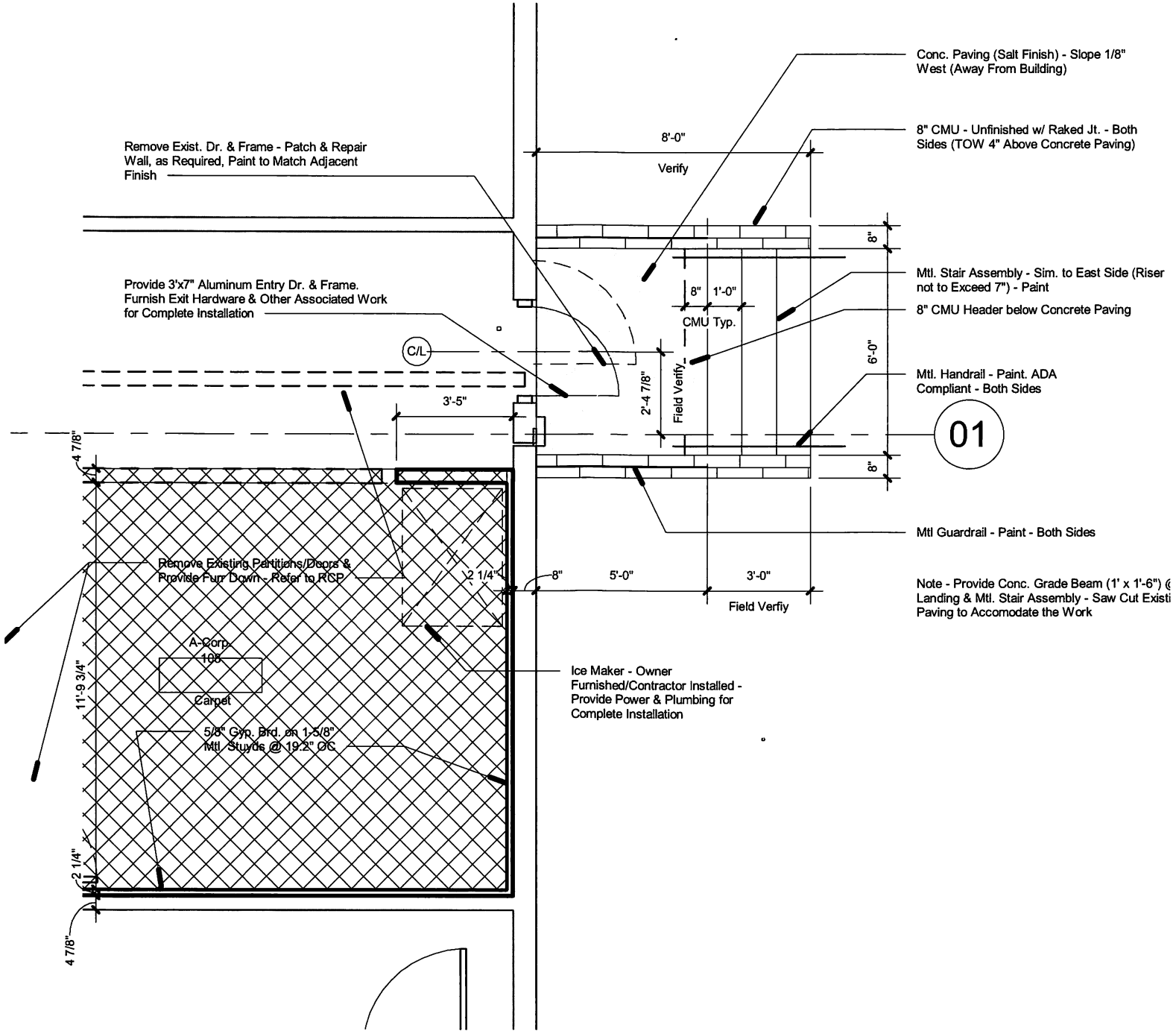

① Level 1 - Supp. Dwg 34A
 1/4" = 1'-0"

ROBERT DURHAM
 ARCHITECTURE

8545 Crichton Court
 Cleburne, TX 76033

1 214.673.4480

robert@rdurhamarchitecture.com
 www.rdurhamarchitecture.com

Door & Landing Plan - West Side
 Renovation - Sheriff's Office

Johnson County Sheriff's Office
 1102 E. Kilpatrick
 Cleburne, TX 76033

SD 34A

Scale 1/4" = 1'-0"

1/11/2023 5:06:08 PM

01

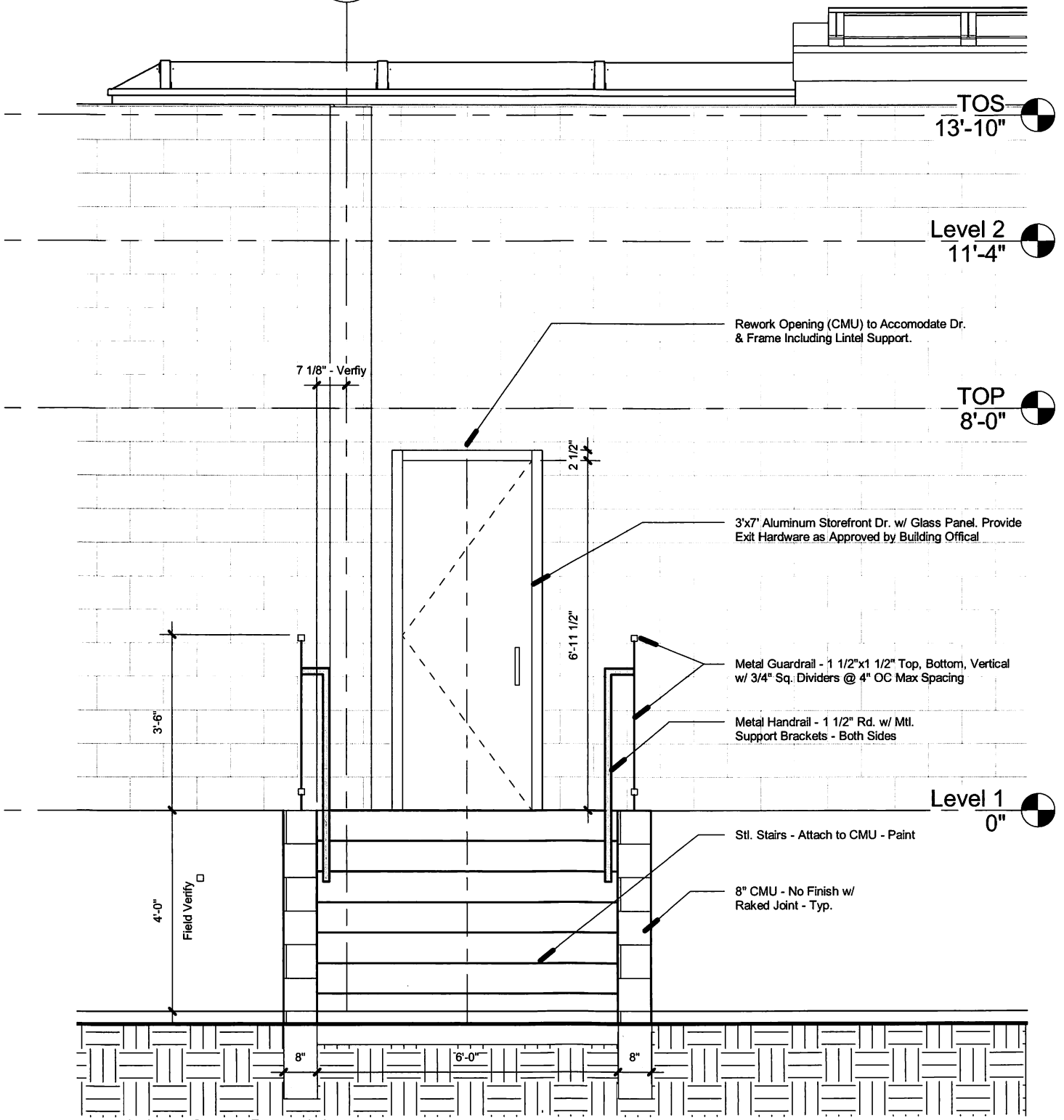

TOS
13'-10"

Level 2
11'-4"

TOP
8'-0"

Level 1
0"

Rework Opening (CMU) to Accomodate Dr. & Frame Including Lintel Support.

3'x7' Aluminum Storefront Dr. w/ Glass Panel. Provide Exit Hardware as Approved by Building Official

Metal Guardrail - 1 1/2"x1 1/2" Top, Bottom, Vertical w/ 3/4" Sq. Dividers @ 4" OC Max Spacing

Metal Handrail - 1 1/2" Rd. w/ Mtl. Support Brackets - Both Sides

Stl. Stairs - Attach to CMU - Paint

8" CMU - No Finish w/ Raked Joint - Typ.

7 1/8" - Verify

2 1/2"

6'-11 1/2"

3'-6"

4'-0"

Field Verify

8"

6'-0"

8"

1 West Supp Dwg 34
3/8" = 1'-0"

ROBERT DURHAM
ARCHITECTURE

8546 Crichton Court
Cleburne, TX 76033
t 214.673.4480

robert@rdurhamarchitecture.com
www.rdurhamarchitecture.com

West Elevation

SD 34B

Renovation - Sheriff's Office

Johnson County Sheriff's Office
1102 E. Kilpatrick
Cleburne, TX 76033

Scale 3/8" = 1'-0"

1/11/2023 5:06:10 PM

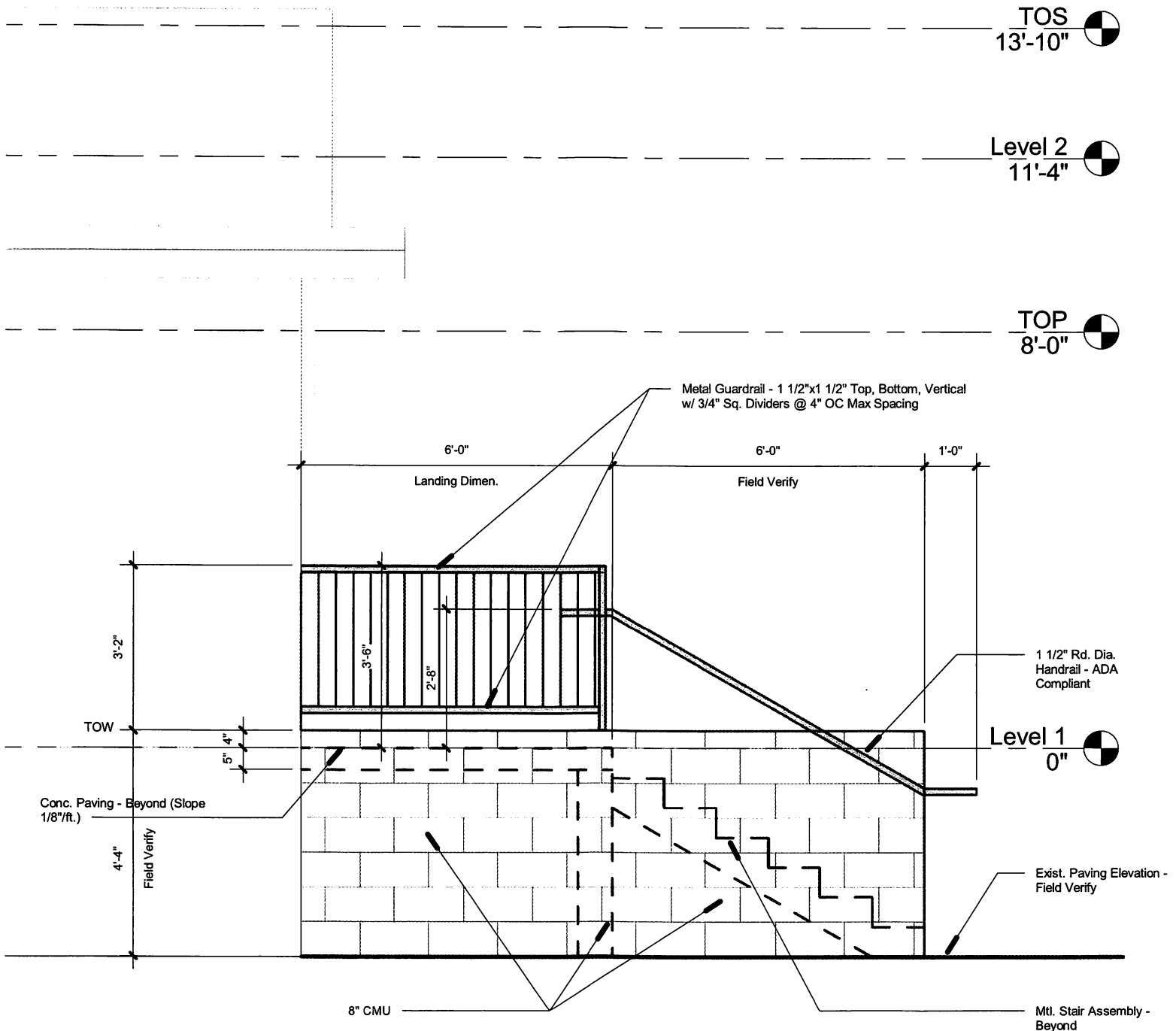

1 North Phase 4
 3/8" = 1'-0"

ROBERT DURHAM
 ARCHITECTURE

8545 Crichton Court
 Cleburne, TX 76033

t 214.673.4480

robert@rdurhamarchitecture.com
 www.rdurhamarchitecture.com

North Elevation @ West Entry
 Renovation - Sheriff's Office

Johnson County Sheriff's Office
 1102 E. Kilpatrick
 Cleburne, TX 76033

SD 34C

Scale 3/8" = 1'-0"

1/12/2023 10:53:18 AM